

GF11BA Black Anodized Bulbing Rivet

Dome head · Aluminium (black anodized) body · Aluminium stem · Multi-grip · Folding
4.0 mm (5/32") - 4.8 mm (3/16")

Features

- Split tail formation provides a very large blind side bearing area against the rear sheet
- Spreads the tail bearing load/clamp load on the rear sheet providing high resistance to pull-out loads
- Multi-grip capability accommodates wide variations in material thickness
- Ideal for use with plastic and low strength material
- Retained stem avoids damage, electrical problems or rattling caused by loose stems

Material

- Body: Aluminium alloy A5052, black anodized
- Stem: Aluminium alloy 5056, polished

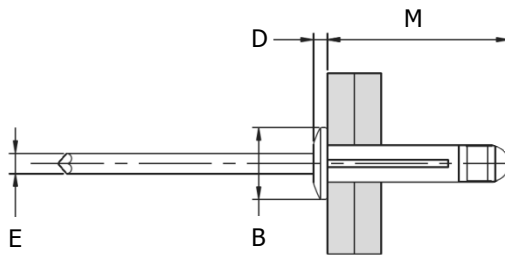

Before Placement

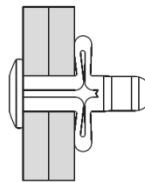

After Placement

Part No.	Size ø	Grip Range		Hole Size		M max.	øB max.	D max.	øE max.	Shear (typical) kN	Tension (typical) kN
		min.	max.	min.	max.						
GF11-0516	4.0 (5/32")	1.0	3.0	4.2	4.5	16.0	8.2	1.6	2.3	0.6	1.0
GF11-0523		1.0	7.0			21.2					
GF11-0619	4.8 (3/16")	1.0	4.0	5.0	5.3	18.3	10.1	2.1	3.0	0.8	1.1
GF11-0625		1.0	9.0			23.3					
GF11-0630		4.0	12.0			27.1					



Can't find what you are looking for?

We can provide customized finishing and colouring.
Contact your nearest [Gripwell](#) team for assistance!